

MS TECHNO SEAL



One part, moisture curing, MS Polymer adhesive sealant. General purpose, excellent adhesion to a wide range of surfaces, **MS Techno Seal** is suitable for joints and elastic sealing both inside and outside.

- Pasty, non slumping, it is permanently flexible and elastic
- Solventless, isocyanate free, odourless
- Virtually no shrinkage
- Flexible at low (-40°C) and high (+ 100°C) temperatures
- Neutral reaction, non corrosive
- Fast curing, skin formation time 10/15 min.
- High elongation
- Compatible with many painting systems (test suggested before use)
- Excellent adhesion to many substrates
- High resistance to ageing, water and UV radiation
- Suitable for outside and inside applications
- Paintable after a short time after application
- Reusable cartridge for a few months with a simple nozzle change

Typical uses

- Sealing of cement, concrete, drywall, masonry, brick, tile, ceramic, glass, galvanized steel, painted steel, stainless steel, anodized and painted aluminum, uPVC, ABS, fiberglass, wood, polystyrene, polyurethane foam.
- Installation of plumbing and guttering, cladding panels, roofing insulation material.
- Sealing of doors, exterior doors, bins
- Sealing of metal carpentry / wood subject to high movement.
- Sealing of means of transport such as motor homes, boats and industrial vehicles.

Properties

Base material : MS Polymer
Consistency : paste
Application temperature : +5° +35°C

Availability

Code	Colour	Packaging	pcs./box
1004446	grey	290 ml. cartridge	24
1004457	white	290 ml. cartridge	24

600 ml. sausages and 25 Kg. drums available on request.

Technical data

Specific gravity :	1,58 kg/dm ³
Shore A Hardness :	40
100% modulus (DIN 53504) :	0,7 MPa
Tensile strength (DIN 53504) :	1,7 MPa
Elongation at break :	700 %
Tear resistance (ASTM D 624-73) :	10 N/mm
Skin forming time :	10-15 min.approx. (20°C 50% R.H.)
Curing speed :	2-3 mm at 24 hours (20°C 50% R.H.)

Values given in this table must not be considered as specifications

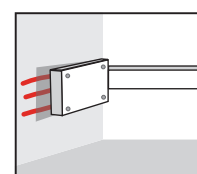
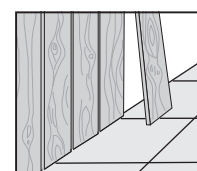
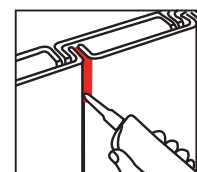

MS TECHNO SEAL



Method of use

Adhesion and surface preparation: MS Techno Seal has excellent adhesion without Primer to degreased surfaces of steel, galvanised steel, anodized aluminium, to many painted surfaces, to concrete, wood, glass, ceramics, GRP, uPVC.

In particular conditions, i.e. humidity and porous surfaces, the adhesion can be improved by application of a suitable primer.

More detailed informations about surface conditioning are available in the selection chart of "Primers for MS Sealants and adhesives".

Application: apply the sealant with continuity using appropriate pressure against the walls of the joint.

Within about 10-15 minutes from the application the sealant can be smoothed or finished.

Size of the joint: a joint properly realized ensures maximum absorption capacity of the movements on the part of the sealant, and then long life and efficiency of the sealing.

The joints subject to movement should have size and shape compatible with the elongation capability of the sealant: sections of rectangular shape with a depth less than the width and adhesion only on the side walls, minimize the stress on adhesion, and risks of tearing. For a correct dimensioning of the section and to avoid that the sealant will adhere to the third wall, it is recommended the inclusion in the joint **FILTENE**, a closed cell polyethylene foam round profile

Storage stability

12 months (290 ml. cartridge), 18 months (600 ml. sausage), 6 months (25 Kg. drum) for the product stored in the original sealed pack at a temperature range from + 5°C to + 25°C.



Fratelli Zucchini S.p.A.

Via C. Colombo, 6 - 44124 Ferrara - Italy

Tel. + 39 0532 782711 - Fax +39 0532 732121

info@zucchini.it - www.zucchini.it

COMPANY WITH
QUALITY SYSTEM
CERTIFIED BY DNV GL
= ISO 9001 =

All recommendations relating to application and use of Fratelli Zucchini S.p.A. products have been given in good faith based on Fratelli Zucchini S.p.A. knowledge and experience, and for products appropriately stored, handled and applied in normal conditions, as indicated in their respective Technical Datasheet. The variability of materials, substrates and conditions of use is such that no warranty of their functionality for a specific application can be deducted from this information, written recommendation or any other type of suggestion offered. Each user has the responsibility to complete adequate evaluations on the efficacy of the materials offered by Fratelli Zucchini S.p.A., of its products, services, recommendations and suggestions for the specific application need, and must accomplish sufficient testing to ascertain that the final product will be safe and sound for the final intent of the end-user. Fratelli Zucchini S.p.A. cannot be considered liable for any damage, direct or indirect derived by a wrong or incorrect use of the products.